

## DVTS 500 HE TUMBLER

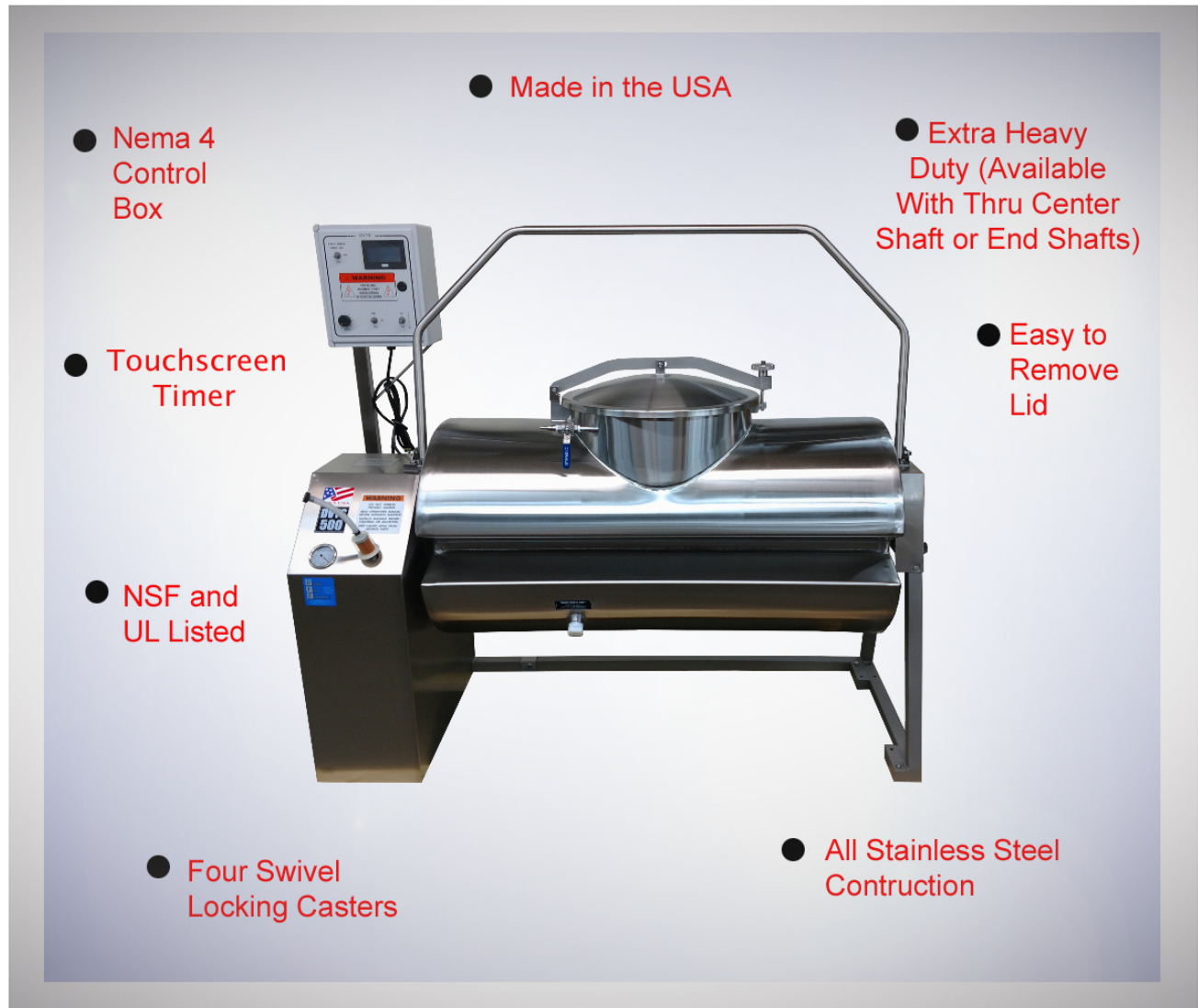

If you're looking for a extra heavy duty quality tumbler then you found it. The DVTS 500 HE tumbler has variable speed control, 0 to 15 rpm. Easy to clean. Safety bar and safety switch. Touchscreen timer in hours and minutes, also does batch counting. Nema 4 control panel. Forward and reverse tumbling. Jog switch so you can rotate the tank to just where you want it for loading, unloading and cleaning. Has two vacuum filters. Liquid filled vacuum gauge. Drain plug. 115 volt. Optional paddle for aggressive tumbling or mixing. Gain profits by tumbling, weight gain and tenderizing all in minutes.

# **DANIELS FOOD EQUIPMENT**

## **DVTS 500 HOSTILE ENVIRONMENT TUMBLER**

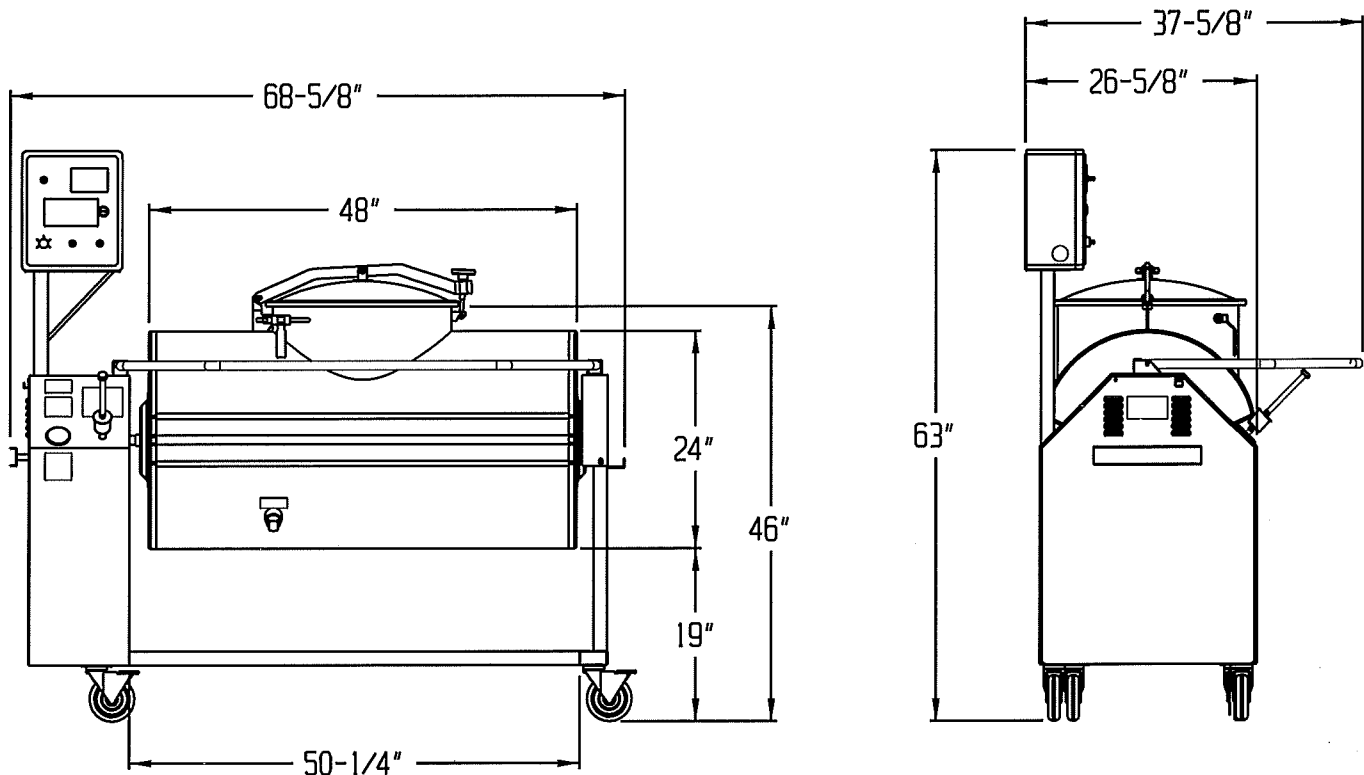

### **SPECIFICATIONS**

<b>TOTAL POWER INPUT:</b>	12-1/2 AMP, 115 VOLT, 60 HZ AC, 1 PHASE
<b>TUMBLER DRIVE:</b>	VARIABLE SPEED CONTROL, FWD/OFF/REV
<b>DRIVE MOTOR:</b>	1/2 HP
<b>VACUUM PUMP:</b>	1/4 HP 115 VOLT, 60 HZ, 1 PHASE
<b>TOUCH SCREEN TIMER:</b>	HOURS, MINUTES, BATCH COUNTING
<b>ELECTRONIC CONTROLS:</b>	TUMBLER SPEED-ADJUSTABLE 0-15 RPM "JOG"- "RUN" TOGGLE SWITCH, "FWD"- "REV" TOGGLE SWITCH, "START"- "STOP" TOGGLE SWITCH, VACUUM PUMP "START"- "STOP" TOGGLE SWITCH
<b>MAXIMUM CAPACITY:</b>	550-LBS.
<b>WEIGHT:</b>	420-LBS. (NET)
<b>FEATURES:</b>	DOUBLE ROW CHAIN AND SPROCKETS, CENTER SHAFT THROUGH TANK OR END SHAFTS

### **DANIELS FOOD EQUIPMENT**

310 NORTH CLAYBORN AVE. PARKERS PRAIRIE, MN. 56361 PHONE: (218) 338-5000 FAX (218) 338-5909.

WEB: [www.danielsfood.com](http://www.danielsfood.com)

E-MAIL: [danielsfood@midwestinfo.net](mailto:danielsfood@midwestinfo.net)